

Bona Super 10 Belt Sander AM0001506 Super 10 handle

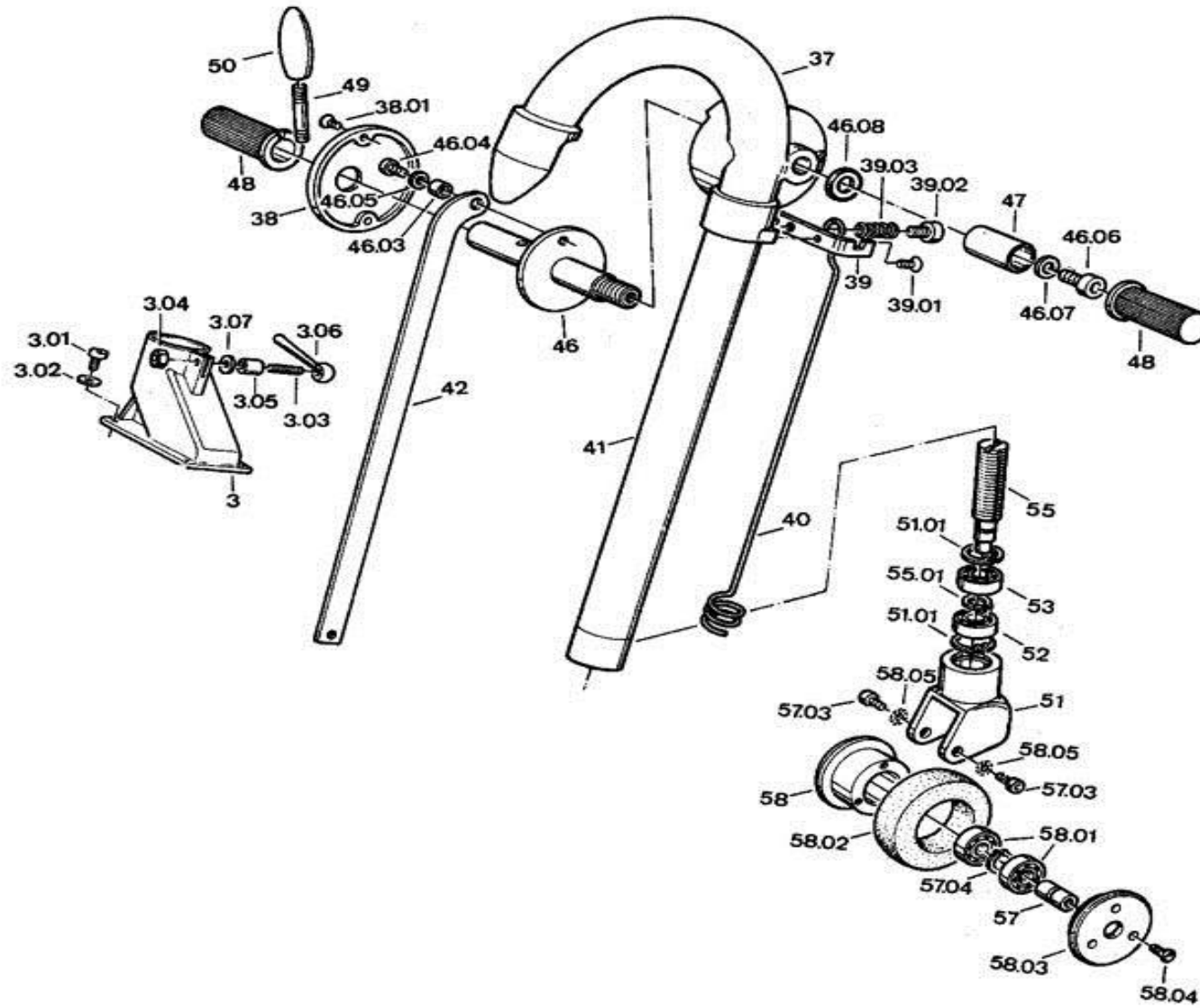

Bona Super 10 Belt Sander AM0001506 Super 10 handle

03.00 .	AS2303.00	DUST PIPE SUPPORT (SUPER 10)
03.01 .	AS2203.01	Mounting screws
03.02 .	AS2203.02	Spring tooth lock washers
03.03 .	AS2203.03	CLAMPING SCREW
03.05 .	AS2203.05	SPACER #3.05
03.06 .	AS2203.06	LOCKING LEVER #3.06
03.07 .	AS2203.07	Washer
37.00 .	AS2337.00FE	S10 FEATHER HANDLE STEER.HEAD
38.00 .	AS2238.00FE	FEATHER HANDLE COVER PLATE
38.01 .	AS2238.01	MOUNTING SCREWS (COVER PLATE)
39.00 .	AS2239.00	CABLE ARM BRACKET (S39.00)
39.01 .	AS2239.01	CABLE ARM BRACKET MOUNT
39.02 .	AS2239.02	LOCKING SCREW
39.03 .	AS2239.03	PRESSURE SPRING (39.03)
40.00 .	AS2240.00	CABLE ARM (S40.00)
41.00 .	AS2341.00	Dust Pipe for Super 10"
42.00 .	AS2242.00	Control Rod
46.00 .	AS2246.00F	RIGHT FEATHER HAND GRIP METAL
46.03 .	AS2246.03	SPACER FOR SCREW
46.04 .	AS2246.04	RETAINING SCREWS
46.05 .	AS2246.05	Washers
46.06 .	AS2239.02	LOCKING SCREW
46.07 .	AS2246.05	Washers
46.08 .	AS2246.08	Washer (Right hand grip)

47.00 .	AS2247.00	LEFT HAND GRIP METAL
48.00 .	AS2248.00	RUBBER GRIP (\$48.00)
49.00 .	AS2249.00	HEIGHT REGULATING LEVER
50.00 .	AS2250.00	PLASTIC KNOB (\$14.06/\$50.00)
51.00 .	AS2251.00	FORK ONLY SUPER 8
51.01 .	AS2251.01	LOCKING RINGS (\$51.01)
52.00 .	ASO916202	Ball bearing 6202-2RSH/C3
53.00 .	ASO916003	Ball bearing 6003-2RSH
55.00 .	AS2255.00	Casoring Shafts
55.01 .	AS2255.01	Locking nut
57.00 .	AS2257.00	Castor Wheel Axles
57.03 .	AS2257.03	Retaining screw
57.04 .	AS2257.04	Locking Ring
58.00 .	AS2258.00	CASTER WHEEL FELLOE
58.01 .	ASO916202	Ball bearing 6202-2RSH/C3
58.02 .	AS2258.02	TIRE (\$59.02)
58.03 .	AS2258.03	FELLOE COVER (\$58.03)
58.04 .	AS2258.04	Retaining screws
58.05 .	AS2258.05	Spring tooth lock washers