

# Bona<sup>®</sup>

## USER MANUAL

(Original)

BONA AB  
A0800195



# BONA<sup>®</sup> DCS25

Handy Industrial Vacuum Cleaner for Floor Grinding etc. with  
Fine Dust and Dust Hazardous to Health

**IMPORTANT!**

Read this manual before you start using the machine.



## Table of Contents

General Description .....	5
Safety Precautions .....	6
Technical Data .....	10
Standard Accessories .....	11
Applications .....	12
Description of the Main Parts .....	12
Motor Top with Suction Motor and HEPA-filter .....	12
Motor Top with Alarm and Shock Valve .....	13
Collection Container and Collection Bag .....	14
Adjustment of the Telescopic handle .....	14
Mounting the Collection Bag .....	15
Mode of Operation .....	16
Assembling .....	17
Starting the BONA DCS25 and Collecting Dry Dust .....	17
Electrical Outlet with Automatic Start/Stop .....	17
Cleaning the Pre-Filter / Membrane Filter during Operation (as needed or when the alarm beeps) .....	19
Emptying .....	20
Asbestos and Dust Hazardous to Health .....	21
Cleaning and Maintenance .....	22
Maintenance of the Motor Top .....	22
Change of Filters	
Check and Replacement of the Membrane Filter .....	23
Replacing the HEPA-filter (item no. 84.67.5006) .....	23
Disposal of Used Filters .....	23
Troubleshooting .....	26
Declaration of Conformity .....	27

# BONA DCS25



Before using the machine, please read this manual.

This user manual must be kept available for the operator at all times.

## General Description

BONA DCS25 is an industrial vacuum cleaner developed for the collection of very fine and health hazardous dust. BONA DCS25 meets the requirements for vacuum cleaners within the industry and the construction industry today. The machine is ideal for the collection of fine and health hazardous dust, such as wood dust or dust from grinding/sanding machines. The machine is also ideal for use in connection with hand tools.



- Teflon-coated pre-filter (BIA dust class "M")
- Filter cleaning during operation with back flush valve
- HEPA-filter (BIA/IFA dust class "H")
- Protection level IPX4 (IEC 60 529)
- Satisfies the demands of EN 60 335-2-69 Annex AA, for collection of health hazardous dust in dust class "H"
- Electrical outlet with automatic start/stop
- Beeper alarm in case of too low air flow
- Soft start of motor
- Post-suction when using automatic

The user manual is to ensure a secure operation of the vacuum cleaner, and to secure that the user is in no way uncertain as to the use. The manual must be stored near the vacuum cleaner. Does any uncertainty arise as to the use of the vacuum cleaner or the material collected, the work should be stopped until all questions have been cleared.

Pictures and drawings are for illustrative purpose and will make the understanding of the manual easier. The pictures shown may therefore be different from the actual product.

## Safety Precautions

This appliance is not intended for use by persons (including children) with reduced physical, sensory or mental capabilities, or lack of experience and knowledge, unless they have been given supervision or instruction concerning use of the appliance by a person responsible for their safety. Children should be supervised to ensure that they do not play with the appliance.

- The appliance is NOT approved for collection of flammable, explosive, poisonous or extremely health hazardous dust, fluids or gasses.
- DO NOT USE THE VACUUM CLEANER WITHOUT A PROPER GROUND CONNECTION. This vacuum cleaner is designed to be used with a grounding connection, in an installation with HFI or HPFI. The user is responsible for ensuring that the wall outlet is grounded. The ground connection of the plug must NOT be removed.
- BONA DCS25 must be connected to 230 V power supply. Make sure that the voltage and safety fuse of the power supply correspond with the data of the data plate and the information given in this manual.
- BONA DCS25 may be used for collection of dust hazardous to health according to CEI/IEC 60335-2-69 Annex AA, dust class H.
- The appliance must be emptied after use.
- The user must ensure that the appliance is adjusted to the task and that regulatory requirements are met.
- When collecting dust hazardous to health you must use a collection bag, and disposal must comply with the legal requirements for material (closed container, plastic bag etc.).
- Avoid damaging the supply cord. When replacing the supply cord, only use an original supply cord (see the spare parts list). The replacement must be carried out by an authorized dealer or an equally qualified person in order to avoid danger. Regularly check the mains connection for damage, such as fissures or ageing. If damage is found, the supply cord must be replaced before further use.
- The plug must be removed from the power supply before repair and maintenance or cleaning operations.
- The mains socket of the machine is to be used only for the purposes specified in the user manual.
- This machine is intended for commercial use, e.g. in hotels, schools, hospitals, factories, shops, offices and rental businesses.
- **Before use**, operators should be provided with information, instruction and training for the use of the appliance and the substances for which it is to be used, including the safe method of removal and disposal of the material collected.
- For user servicing, the appliance must be dismantled, cleaned and serviced, as far as is reasonably practicable, without causing risk to the maintenance staff and others. Suitable precautions include decontamination before dismantling, provision for local filtered exhaust ventilation where the appliance is

dismantled, cleaning of the maintenance area and suitable personal protection.

- In the case of class H appliances the outside of the appliance should be decontaminated by vacuum cleaning methods and wiped clean or treated with sealant before being taken out of a hazardous area. All the appliance parts shall be regarded as contaminated when removed from the hazardous area and appropriate action taken to prevent dust dispersal.
- The manufacturer, or an instructed person, shall perform a technical inspection at least annually, consisting of, for example, inspection of filters for damage, air tightness of the appliance and proper function of the control mechanism. On class H appliances the appliance filtration efficiency should be tested at least annually, or more often, according to national requirements. The test method that may be used for the verification of the appliance filtration efficiency is given in AA.22.201.2. If the test is not passed, it must be repeated with a new essential filter.
- When carrying out service or repair operations, all contaminated items, which cannot be satisfactorily cleaned, are to be disposed of. Such items shall be disposed of in impervious bags in accordance with any current regulation of the disposal of such waste.
- The upper part of the motor top is not a dust proof compartment, and when cleaning, the covers of this compartment are removed by loosening the screws fixing the covers.

**IMPORTANT! The vacuum cleaner must not be started with covers removed.**

**When the automatic start/stop is activated in connection with electrical hand tools, you must ALWAYS turn off the hand tools before you turn off the machine.**

**IMPORTANT! The motor top must not be covered when the vacuum cleaner is in use.**

### **Guidelines in Connection with Disposal of the Machine**



The product you have purchased is subject to Directive 2002/96/EC of the European Parliament and the Council of the European Union on waste electrical and electronic equipment (WEEE) and should not be disposed of as unsorted municipal waste. Please utilize your local WEEE collection facilities in the disposition of this product and otherwise observe all applicable national requirements.

Does the safe use or maintenance of the appliance raise any questions; do not hesitate to contact either your dealer or BONA AB.

## General Safety Instructions

---

When using electrical equipment the necessary safety precautions must be taken in order to avoid the risk of fire, electrical shock and damage to persons. The below safety instructions are to be read and followed when the vacuum cleaner is being used.

---

1. Keep the working area clean. Slippery and greasy surfaces increase the risk of accidents.
2. Be aware of the surroundings.  
Do not expose the vacuum cleaner to rain. Do not use the vacuum cleaner in moist or wet surroundings. Do not use the vacuum cleaner near flammable gasses or liquids.
3. Protect against electrical shock.  
Avoid bodily contact with earthed building parts, such as radiator, water pipes and the like and also electrical appliances with their own earth connection.
4. Keep children and unauthorized persons away from the workplace.  
Do not let unauthorized persons touch the vacuum cleaner or the supply cord. All unauthorized persons should be kept at a distance.
5. Put the vacuum cleaner away, or make it ready for transport after use.  
Keep the vacuum cleaner in a dry place and inaccessible to children.
6. Do not use force.  
Do not use force when operating the vacuum cleaner.  
Do not step on the hose, or the electrical cord.
7. Choose the correct tool, accessories for the task.  
Do not use badly proportioned or light tools for heavy tasks.  
Do not use tools for anything they are not intended for.
8. Choose suitable working clothes.
9. Personal protective equipment.  
Put on eye and/or ear protection, if necessary. Put on respirator in dusty environments.
10. Protect the electrical cord.  
Never carry the vacuum cleaner in the electrical cord. Do not remove the plug from the socket by pulling the electrical cord. Keep the electrical cord away from heating sources, oil and sharp edges.
11. Choose a safe working position so that there will be no risk of falling in the hose and cord.

## Manual

12. Keep the machine and equipment in good repair.  
Keep the vacuum cleaner clean and dry and follow the instructions of the chapter about maintenance.
13. Cut off the electricity supply when the vacuum cleaner is not in use.  
Remove the plug from the socket before maintenance, repair and when the vacuum cleaner is not in use.
14. If extension cords are used outdoors, they must be approved for this.  
If extension cords are used, the following guidelines must be observed:

Length of cord in metres	Cross section	
	<16A	<25A
Up to 20 m	Ø1,5mm <sup>2</sup>	Ø2,5mm <sup>2</sup>
20-50 m	Ø2,5mm <sup>2</sup>	Ø4,0mm <sup>2</sup>

15. Show attention and be rested.  
The vacuum cleaner must not be used, if the user is tired, sleepy or sick or under the influence of alcohol or drugs / medicine.
16. Check for damage.  
Check the vacuum cleaner for damage. Check that the shields etc. have been properly fastened. Check the electrical switches, and have an authorized service mechanic replace them, if they are damaged. Do not use the vacuum cleaner, if it cannot be started and/or stopped at the switch.

BONA DCS25 is H-classified in accordance with the demands of EN 60335-2-69 Annex AA for collection of dust hazardous to health.

BONA DCS25 is furthermore in accordance with the Machinery Directive (2006/42/EC).

<b>H</b>	<b>WARNING:</b> This appliance contains dust hazardous to health. Emptying and maintenance operations, including removal of the dust collecting means, must only be carried out by authorized personnel wearing suitable personal protection. Operate only after the full filtration system has been fitted and checked.	<b>H</b>
----------	--	----------

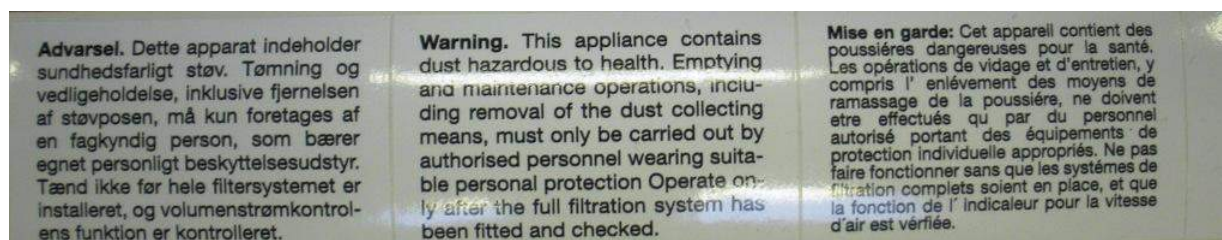

Three labels are enclosed. One in Danish, one in English and one in French.

The standard language of the label on the machine is German. Therefore the label with the language of the country in question is to be placed on the H-label, with the text as shown above.



### Technical Data

The machine is connected to 230 V power supply.

The survey below shows the technical data of BONA DCS25.

**Make sure that the voltage and fuse of the power supply correspond with the data of the data plate of the machine and the data of this manual.**

	EU	
Voltage	230	Volt
Suction motor	1450	Watt
Power outlet, max.	2000	Watt
Vacuum	3000	mmWc
	29,5	kPa
Air volume, max.(nom.)	54 (43)	l/sec.
	194 (155)	m <sup>3</sup> /h
*Suction power, max. ((P2)based on IEC 60312)	415	W
Filter area, membrane filter	0.12	m <sup>2</sup>
Filter area, HEPA	1.1	m <sup>2</sup>
Collection capacity (bag)	16	l
Height (max/min)	1070/830	mm
Length	550	mm
Width	500	mm
Weight without accessories	20,5	kg
Container coupling	Ø 50	mm
Length of supply cable	8	m
<b>Noise</b>		
Based on ISO 11201		
Machine pressure level : uncertainty K <sub>pA</sub> =3dB (Measured only as machine)	<70	dB(A)
Based on EN 60704-1:2010 and EN60704-2-1:2001		
Max. Sound Power Level L <sub>WA</sub> = uncertainty K <sub>WA</sub> =3dB (Measured with hose, pipes and floor accessory)	<85	dB
<b>Vibrations</b>	≤ 2,5	m/s <sup>2</sup>

\*Data of the machine with 4 metres ø 38 hose



In connection with extraction from tools (dust extractor) it is necessary to ensure a sufficient rate of air renewal (L) in the room.  
According to the instructions from The Danish Working Environment Service, recirculation of extracted air is forbidden. Please refer to national regulations.

## Standard Accessories

BONA DCS25 is delivered with a complete set of accessories including tubes, hose and all the necessary nozzles.

You can reorder the accessories using the following product numbers:



1. Plastic hose - 7,5 m .....	84.54.3876
2. Crevice nozzle .....	80.34.4007
3. Floor nozzle B-370 .....	84.38.3620
4. Straight tube .....	80.52.3651
5. Bent tube .....	80.52.2150

## Applications

BONA DCS25 is a vacuum cleaner in accordance with DS/EN 60335-2-2 and CEI/IEC 60335-2-69 Annex AA class H and may only be used as such.

BONA DCS25 may be used for collection of dust hazardous to health according to CEI/IEC 60335-2-69 Annex AA dust class **H**.

BONA DCS25 may **not** be used for collection of fluids or moist dust.

BONA DCS25 may **not** be used for collection of flammable, explosive, poisonous or other dust, fluids or gasses hazardous to health.

BONA DCS25 may only be used in dry environments and may not be used or stored outdoors or indoors under wet conditions.

The capacity of a vacuum cleaner to suck vacuum depends on the air. Theoretically, the suction capacity will fall when the vacuum cleaner is used at altitudes. The suction capacity of the vacuum cleaner will be constant from 0 to approx. 800 m above sea level. From 800 to 2000 m the suction capacity will theoretically fall to approx. 75%. It is not recommended to use the vacuum cleaner at more than 2000 m above sea level, as the cooling and the suction capacity will be considerably reduced.

## Description of the Main Parts

BONA DCS25 is designed as a handy and compact industrial vacuum cleaner for collection of fine dust and dust hazardous to health.



### Motor Top with Suction Motor and HEPA Filter

The motor top is equipped with suction motor, an integrated handle, switches for the suction motor and the built-in automatic start-/stop.

The powerful suction motor of BONA DCS25 is placed in the motor top.

## Manual



The motor top is fitted with a HEPA filter in dust class "H".

The filter blocks the fine and smallest dust particles, which have not been held back by the membrane filter. The filter holds back the particles larger than 0.3  $\mu\text{m}$  (0.0003 mm). Filter surface : 1.1 m<sup>2</sup>.

To get to the HEPA filter, the pre-filter / membrane filter must be removed.



### Motor Top with Alarm and Shock Valve

The motor top is equipped with a shock valve for cleaning the pre-filter, and an acoustic alarm, which will beep when the air flow is too low (<20 m/sec). Furthermore, the control panel has a red LED lamp which will visually indicate when the alarm sounds.



Electrical hand tools can be connected directly to the BONA DCS25.  
(MAX 2000 W)

## Manual



### Collection Container and Collection Bag

The collection container is equipped with a telescopic steering handle and 2 swivel wheels.

The collection container contains the collection bag where the material is collected, which facilitates the emptying and disposal of the material collected.

The collection bag cannot be filled entirely when very fine dust is collected (eg. cement, stone grinding etc.).

When collecting dust hazardous to health you must pay attention to the requirements as to disposal of the collected material. (Closed container; plastic bag or container). The demands as to packing of the material collected may vary.

### Adjustment of the Telescopic handle

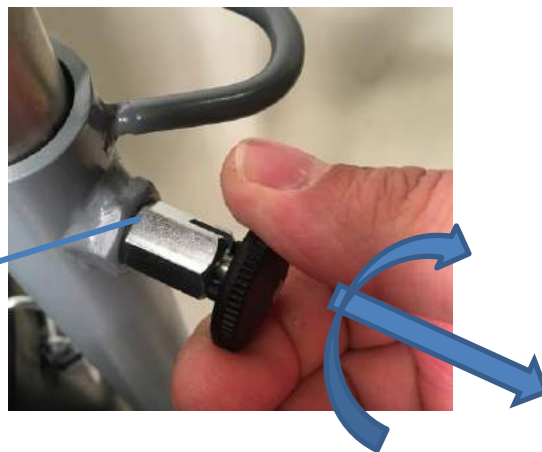

To use the telescopic handle – pull and turn to release the position bolts on the rear side of the frame. The handle can be adjusted – pulling up-wards or pushing down-wards.

To lock the position bolt, and lever – turn the bolt-head until it “clicks” into locked position, then adjust the handle until it “clicks”

Open

Locked





## Mounting the Collection Bag

The collection bag is easily mounted into the bag holder by pushing the flange of the collection bag into the slot of the bag holder.



**IMPORTANT!**  
**DO NOT USE THE VACUUM CLEANER WITHOUT COLLECTION BAG**

## Mode of Operation

When the suction motor of the machine is on, the air will be led through the machine and will collect the dust particles near the nozzle mounted.

The dust particles will be sucked through the hose into the collection container, where the majority of the particles will be held back in the collection bag and/or the pre-filter / membrane filter.

The air flow and the remaining particles, which have not been held back inside the collection bag or the pre-filter / membrane filter, will be carried forward to the HEPA filter.

From the HEPA filter the purified air flow will continue through the suction pump (blow through) and will be led out of the vacuum cleaner through the exhaust and noise reduction filters.

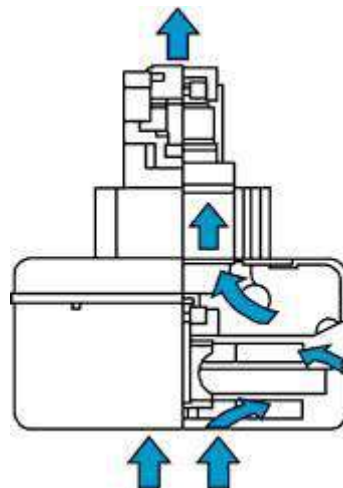

**IMPORTANT!** As the motor leads the cooling air through the machine, all filters **MUST** be mounted and intact.

**IMPORTANT!** Never cover up the motor top when the machine is in use.

**IMPORTANT!** Never collect warm or glowing materials.

**IMPORTANT!** Never extract from processes producing sparks.

## Assembling

- Check that the packing is intact and has no sign of damage from handling and transport.
- Unpack BONA DCS25 and check that all the ordered parts are there.
- Make sure that the collection container is empty, and that the pre-filter / membrane filter is correctly fitted into the motor top. Check that the filters of the machine are intact and undamaged (see the chapter: "Change of Filter")
- Check that a collection bag is mounted in the container.
- Before the plug is connected to the electrical main supply you must make sure that the plug and the cord are undamaged. If the cord or the plug is damaged, a professional must replace the parts. Only an original cord may be mounted.
- Connect the machine to 230 V power supply with a reliable earth connection.
- Remember to place the label onto the H-label, if the language of the user is not German.
- BONA DCS25 is now ready for use. The collection is described in details in the following chapter.

## Starting the BONA DCS25 and Collecting Dry Dust

When the machine has been correctly assembled and connected, it can be switched on and off at the red start/stop switch of the motor top. The machine has been equipped with an acoustic and a visual alarm indicating when the air flow is too low for collection.

This alarm has to be checked before use: Block the intake at the end of the hose, and the machine will start beeping, and the LED will flash. Unblock, and the alarm will stop.

### Electrical Outlet with Automatic Start/Stop



BONA DCS25 is equipped with an automatic start/stop and electrical outlet. If you connect electrical hand tools directly to the power outlet of the motor top, the BONA DCS25 will automatically be switched on and off when the hand tools are switched on and off.

The automatic start/stop is programmed with a post-suction cycle. Therefore, the suction will continue for some seconds after the tool has been switched off.

The electrical tool is connected to the electrical outlet at the back of the motor top.

BONA DCS25 can be used with tools with a power consumption of 2000 W (Country code EU). 1450 W corresponds to a current consumption of approx. 6,3A.

**Information can be found on the data plate of the machine**



## Manual

**NOTE:**

If hand tool with a power consumption of more than 1500 W is connected, the total current consumption will exceed approx. 13 A, which is often the normal fuse size.

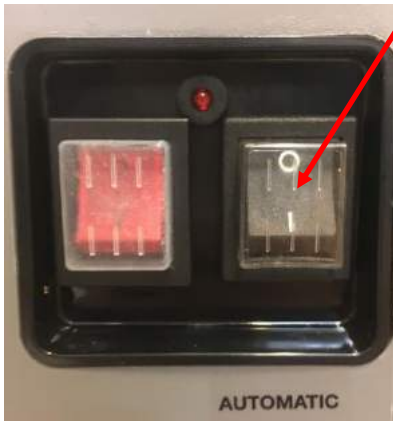

The automatic start/stop is activated with the black switch on the motor top. When the automatic start/stop is activated, the machine will not start when you push the red switch. The machine will not start until the connected hand tool is started.

Set the red switch on "I" to start the vacuum cleaner (when "Automatic" is not needed or no tool connected).

Automatic start/stop "I" = the automatic start/stop is activated. The vacuum cleaner will start when you use the hand tool.

Automatic start/stop "O" = the automatic start/stop is not activated. The vacuum cleaner will start when you set the main switch (red) on "I".

When the automatic start/stop is activated "I" and a hand tool is connected to the electrical outlet, the machine will start when the hand tool is started.



**ALWAYS** turn off the hand tool before you turn off the machine on the switch.

**Cleaning the Membrane Filter during Operation (as needed, or when the alarm beeps)**

Block the intake / hose so that full vacuum is made in the machine.

1.  
Block the intake / Block the hose.  
Take hold of the flap of the shock valve.
2.  
While the machine is blocked and running, pull the flap of the shock valve (do not tug the valve).
3.  
When the power grows bigger than the influence from the vacuum, the valve will automatically open with a "puff". Let of the valve.



Repeat the steps 1-3 approx. 2-3 times when cleaning.

The difference in pressure / the shock effect will clean the surface of the filter, when air is drawn through the valve in order to equalize the negative pressure in the collection container and the hose, and will reject possible deposits from the pre-filter and release collected media from the inside surface of the collection bag.

This method gives an effective cleaning of the pre-filter / membrane filter.

We recommend to always leave the machine for a few minutes before emptying it. The dust will fall to the bottom of the collection bag, and the risk of swirling dust into the surroundings during the emptying is reduced.

If – by mistake – the machine has been used without collection bag, use PPE when emptying the machine.

**NOTE:** Do not "tap" on the intake as this will swirl up the dust in the container and result in blocking of the pre-filter and damaging the collection bag.

## Emptying

The BONA DCS25 collects the material in a collection bag (if collecting dust hazardous to health, a collection bag with a plastic sack must be used)

- Loosen the four container clips attaching the motor top to the collection container and remove the motor top.
- Place the motor top upon a dry and clean surface.
- Close the collection bag.
- Now you can dispose of the collection bag.

**REMEMBER:** Disposal of dust hazardous to health must take place in accordance with the national regulations.

### **REMEMBER: Always empty the machine after use.**

You must make sure that the dust and material collected cannot fall out of the machine during transport.

**Has the machine been used for dust hazardous to health you MUST wear personal protection equipment (PPE) when emptying and handling the machine.**

**Always empty the machine after use.**

**Asbestos and Dust Hazardous to Health**

Always check up on the local/national regulations in the area where the work is performed.

Always examine how the disposal is to be packed/wrapped up.

It might be different from place to place. Usually the following is mentioned:

Close-fitting packing, Drum/vat with cover

Plastic bag min. 100 µm.

Collection of dust hazardous to health must always take place in collection bag. The collection bag must be removed from the machine and disposed of in accordance with the national regulations.

Always mark the materials and waste according to the national regulations.

If the machine has been used for asbestos, the machine must be disassembled and cleaned before it is used in a clean environment.

The machine must be emptied, cleaned and packed before transport. Mark the packing according to the national regulations.

The machine must be transported in a min. 120 µm plastic bag or other tight-fitting packing.

### Cleaning and Maintenance

The machine must always be emptied after use. If the machine is left with dust, there is a risk of self-ignition.

**IMPORTANT!**  
**The machine must not be connected to the power supply during service and cleaning.**

Read the chapter about safety precautions before cleaning and maintenance.

The easiest way to clean the machine is as follows:

- The Pre-filter is cleaned as required.
- Wipe the machine on the outside with a dry or damp cloth.

### Maintenance of the Motor Top

The motor top is made of maintenance-free parts and therefore needs no daily maintenance, apart from external cleaning and check that the cords and plugs are undamaged.

The easiest way to clean the motor top is with a damp cloth. Do not aim jets of water directly at the motor top.

In order to avoid stop in operation and also to make sure that the safety of the vacuum cleaner is intact, it is recommended that the electrical parts are inspected annually by an authorized technician.

It is recommended to have an authorized service centre inspect the motor bushings of the brushes after approx. 800 working hours, and if necessary, replace them. In this way the life of the suction motor is prolonged. If the brushes are not replaced before being completely worn out, the motor may seize up, and this may require a replacement of the motor.

Check / maintenance of the machine

Description	Before/After use	Month / year	Hours
Replace motor			750-800
Check of HEPA filter and machine		yearly	
Emptying and cleaning	After use (as required)		
Check of filters and machine, generally	Before use		
Check of cord, plugs and outlet for tools	Before use		
Check of alarm (beeper)	Before use		

Remember to reorder service parts.

## Change of Filters

### In General

When replacing the filters, the necessary precautions to protect the environment and the respiratory passages of the operator must be taken. The nature and scope of these precautions must be based upon the type of dust being on the surface of the filters. Before checking or replacing the filters, you must clean the filters as previously described, and you must empty the machine. The filters are to be handled in a way not causing any danger, and the safety equipment must be appropriate for the job.

### Check and Replacement of the Membrane Filter



Pull off the membrane filter from the adapter ring / upper part where it is fastened.

- Loosen the four container clips attaching the motor top to the collection container and remove the motor top.
- Place the motor top upside down upon a dry and clean surface.

Inspect the filter; are there any signs that the membrane is damaged, and/or is the filter material torn?

A damaged or worn filter must be replaced.

A replacement of the membrane filter should also include a replacement of the HEPA-filter.

### Replacing the HEPA-filter



- Loosen the four container clips attaching the motor top to the collection container and remove the motor top. Place the motor top in a way that allows access to the filter.
- Pull off the membrane filter to gain access to the HEPA-filter

**To ensure a dust-free emptying when replacing the HEPA-filter, the following procedure must be followed:**

## Manual



Remove the nut and plate which hold the HEPA-filter.  
For this you need a ring spanner size 10.



Be careful not to lose the plate and the locknut as these are to be reused.

Pull a plastic bag (100 my or equivalent) over the filter.

Now, carefully pull the filter off the rod bolt.  
DO NOT jerk or twist the filter, as it can damage the rod bolt.



Close the bag using a cable binder.

Disposal of the filter should always follow the existing rules regarding the vacuumed material.



## Manual



Check the sealing surfaces before the new filter is mounted.

Then mount the new filter.

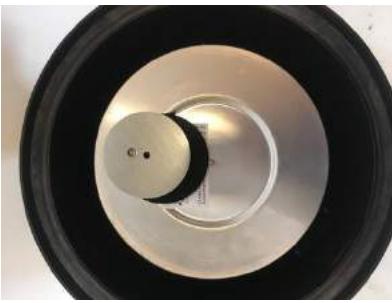

Mount the plate and nut.

Tighten with approx. 25nM.



### **Disposal of Used Filters**

When disposing of the old filters, you must make sure that the requirements of the environmental authorities are followed.



## Troubleshooting

### If the machine does not collect the material in a satisfactory way (alarm beeps):

- The suction hose, tube or nozzle may be blocked.  
*Stop the machine, and remove the blocking.*
- The motor top may not have been correctly mounted, which can cause a leak.  
*Start the machine and block the suction hose. Normally you can hear a possible leak. Loosen the container clips of the motor top, place the motor top correctly and lock the clips again.*
- The collection bag may be blocked.  
*If you collect very fine dust, the collection bag may block before it is completely full. Replace the collection bag.*
- The membrane filter may be blocked.  
*Clean the membrane filter as described in the chapter about cleaning of filter during operation.*
- The HEPA filter may be blocked.  
*Replace the filter as described in the chapter about change of filters.*

### If the machine does not start

- The fuses of the control circuit may have melted.
- The hand tool starts but the machine does not start → The fuse may have melted

The replacement must be made by BONA AB, an authorized BONA AB repair shop or a qualified person in order to avoid hazards.



DECLARATION OF CONFORMITY

V. BRØNDUM A/S  
Sadolinsvej 14  
DK – 8600 Silkeborg

FOR:

**BONA AB**  
Murmansgatan  
SE-20221

V. BRØNDUM A/S

hereby declares that the following product:

Electrically operated industrial vacuum cleaner,  
Classified for dust class "H"

Model:  
BONA DCS25

has been designed and produced in conformity with the basic requirements and other relevant conditions of the following directives:

The Machinery Directive (Directive 2006/42/EF)

The compliance has been achieved by use of the following standards:

EN 60 335-2-69

Verified compliance with standard and directive by: SLG.

Dust class H verified by technical dust test by: SLG

Silkeborg, August 2017

Kennet Vallø  
Product & Quality Manager

Notes:

***Bona***<sup>®</sup>